

Gutterglove^{PRO}

FRAME-REINFORCED STAINLESS STEEL MICRO-MESH

Installation Guide

Product Illustration

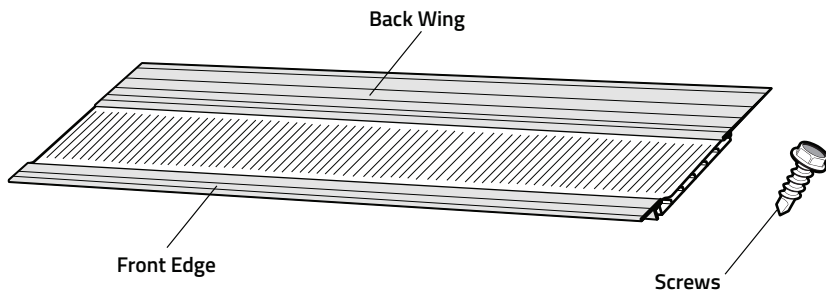

Recommended Tools

- Circular or Chop Saw
- Tin Snips
- Gloves
- Safety Glasses
- Extension Ladder
- Drill
- Tape Measure

Safety Is Our #1 Priority

During installation we recommend that you...

- Wear gloves and safety glasses.
- Use an extension ladder and standoff for stability.
- Make all cuts to the gutter guards on the ground.

ALSO MAKE SURE TO:

- Obey local building codes
- Remove any labels/stickers from the gutter guard piece as needed.
- Check to see if the roofing material is adhered to the underlayment. Do not pry up the shingles or tear the underlayment. Refer to Option 2 in the installation guide

Installation Help

This guide covers a standard installation. If you need additional instructions, please contact us at 886.483.8166 M-F 8AM-5PM CST for assistance.

FREEZING CONDITIONS

If you are in an area that is prone to freezing, inform the customer that the following issues can occur with any gutter guard:

Icicles and Ice Dams

Icicles and ice dams may form on the gutter during freezing conditions. Ice dams can cause water to leak back into the home. Icicles can break and cause serious bodily harm and injury. Properly installed, operated, and maintained heating elements on the roof and gutter can melt icicles and ice dams. Use a local licensed electrical contractor in good standing for installing any heating element products.

Snow Melting

Snowmelt may result in water runoff from the roof which can re-freeze on the ground below creating a potential slipping hazard.

Important Reminder

Missing this step can result in rainwater runoff.

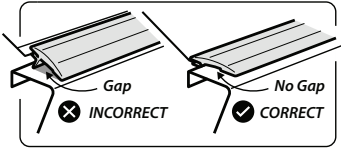

Remove the Gap
There should be no space between the front rail and the gutter lip when you install.

Step 1

Clean And Repair Gutters

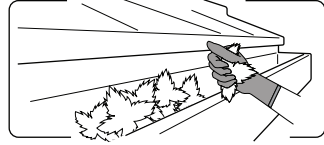

Step 2

Determine Gutter And Roof Slope

Select the option that best resembles your gutter and roof scenario. Once you've identified the roof scenario that best fits, proceed to the corresponding step. Gutterglove Pro gutter guards can be installed with all roof shingle and gutter types

Option 1



Standard Roof
If your roof looks like this, continue to **OPTION 1**.

Option 2

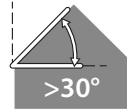

Steeply Pitched Roofs
If your roof looks like this, continue to **OPTION 2**.

Option 1: Standard Roof Installation

Frame-Reinforced Stainless Steel Micro-Mesh gutter guard is designed to slide underneath roof shingles with the optimum slope for gutter guard install being 5-25°. If any of the following situations occur during installation, we recommend installation option 2:

- The roof is steeply pitched, resulting in a slope beyond 25°
- The gutter guard causes the roof shingle to start ramping when slid underneath
- If gutters are installed low below the roofline, causing a steep slope from the roof to the front of the gutter.

Option 2: Below The Roofline Installation

If your roof is steeply pitched or you have a low hanging gutter, the gutter guard will need to be installed against the fascia. We recommend installing the Gutterglove Pro Fascia Mount as a support bracket. The gutter guard will need to be installed at a slope of 5-10°.

Trim the extruded aluminum wing (wider rail frame of gutter guard) to allow the gutter guard to match the width of the gutter.

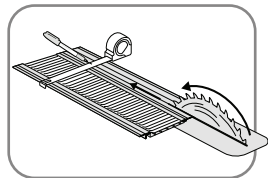

Step 3

Measure And Cut The Gutter Guard As Needed

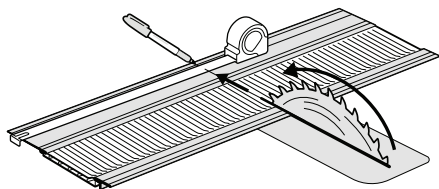

Firmly fasten or clamp Frame-Reinforced Stainless-Steel Micro-Mesh gutter guard to a secure flat surface. Use a circular saw or chop saw (make sure to wear safety goggles!) to cut through the aluminum frame and stainless steel micro-mesh to fit the length and width needed for your installation.

Step 4

Begin Laying First Section

We recommend starting at an inside corner. If there isn't one, start at the downspout.

Option 1: Standard Roof Installation

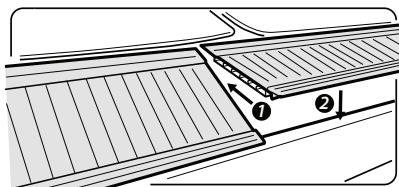

Carefully slide the rear wing of the gutter guard under the roof shingles. Where the mesh extends past the frame on both ends, carefully bend the mesh down so each gutter guard can butt up close to the next. Continue to step 5.

Option 2: Below The Roofline Installation

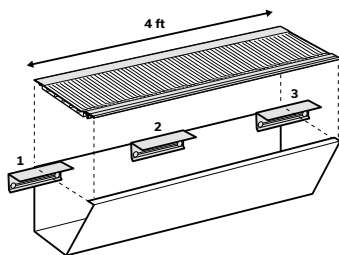

Install Gutterglove Pro Fascia Mount using the installation instructions provided.

Carefully lay the gutter guard with the cut rear wing laying on the fascia mount to support the gutter guard. Continue to step 5.

Step 5

Use Screws To Attach

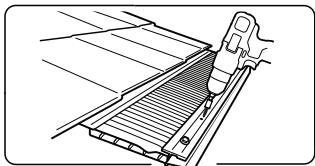

Use the scribe line on the front rail as a guide to place 3 screws for each section. Fasten the screws through the gutter guard rail to the front of the gutter.

Important: When the mesh extends past the end of a section, bend the mesh down to allow another section to butt up against the previous section. **Pro Tip:** Use an aluminum thumb to cover the seams in the gutter guard installation.

How-To: Inside Miters

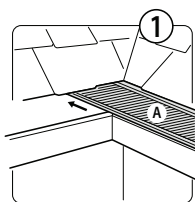

Slide first section all the way to the inside corner of the gutter.

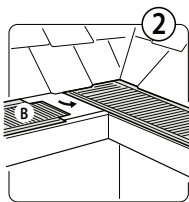

Take a second section of the gutter guard and bring it into the corner to butt up against the first section used in step 1 to form a 90° angle.

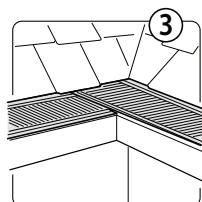

This is a completed inside corner.



If there is a gap due to height differences between the two gutter guard sections, use a scrap piece of mesh or coil aluminum to cover the gap and seal the gutter.

How-To: Outside Miters

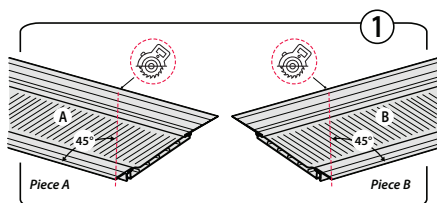

Prior to installing, use a circular or chop saw to cut a 45° angle at the opposite ends of two separate sections.

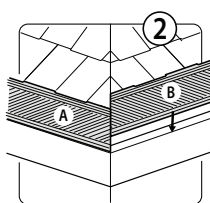

Place the two sections with the cut ends next to one another at the outside miter.

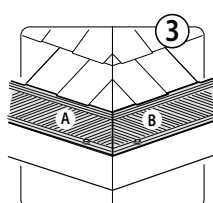

Affix to the outside edge of the gutter and fasten with screws



To provide a more finished look, we recommend fastening an aluminum thumb over the seam.

How-To: End Caps

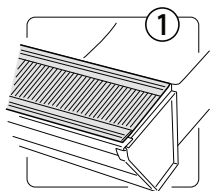

Use a spare piece of mesh or piece of coil aluminum and cover the ends of the guard by bending and wrapping around the end.

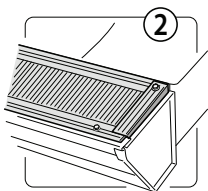

Use a screw(s) to fasten the shaped material to the gutter guard.

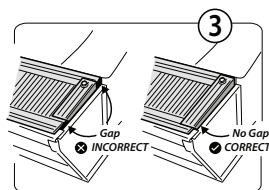

Make sure the entire gutter end is sealed to prevent debris and pests from getting under the gutter guards.



Need More Help?

CLICK HERE

for Installation Videos
and More Information at
gutterglovepro.com/install



or Contact Our Support Team:

customerservice@gutterglove.com

888-334-1209

Monday-Friday 8am-7pm CST

COMPLETING THE JOB

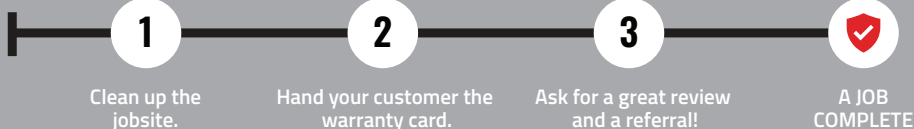

Thank You for Choosing Gutterglove Pro

Gutterglove
PRO

INDUSTRIAL GRADE GUTTER PROTECTION
EXCLUSIVELY MADE FOR PROS